

## **SOCIAL TWEET : SOCIAL PLATEFORM**

**Priyata Mishra** Assistant Professor Department of CSE,SSIPMT Raipur, India  
**Hitisha Chouhan** Department of CSE SSIPMT Raipur, India  
**Nupoor Chandraker** Department of CSE SSIPMT Raipur, India  
**Neelam Yadav** Department of CSE SSIPMT Raipur, India

### **ABSTRACT –**

Online social tweet is a messaging plate-form such as Telegram, Discord, Linked-in, Instagram, facebook and Whats app. In present study organization uses social media application for consumers relationship management. Based on the cluster analysis, in every groups of organizations were using the social media applications. The first three groups primarily used a single social media platform for blogs, widgets on social networking sites to spread there business and work. People uses social media to get famous and gain popularity through social network. Using social networking sites people used to spread there connection spread love and knowledge what they have experienced in there life and many more.

**KEYWORDS –** Network, Online Social Network(OSN), Tweet, Social media web application, Blog, Online safety.

### **I. INTRODUCTION**

Social tweet is a networking plate-form to connect with people and there thoughts In this plate-form one can react, talk to there friends and make connection with peoples.[1] In this project our primary goal is to return the functionalities of twitter app, Functionalities like Profile management, updates, Login, to see followers, follow others and log-out. The plate-form offers real-time updates, likes, comments and notified about the new posts. The social connectivity is also involved in this project like follow/followers and connect with other and give feedback to the user. This project helps understanding the web development practices and also gives the education of data management and real-time system management. Here social tweet is combining different parameters such gender, time and opinion of the users. Online Social Networks(OSN) is where all people connects and interacts and shows the similar interests with world[2]. Twitter is blogging service Launched in 2006, In twitter people shares news and there thoughts called tweets[3], likes and comments on there tweets. Twitter has played an important role in the dissemination of news[4]. Social media has become very common in daily life. People are shooting blogs and videos uploading there lifestyle in media plate- form. In Social tweet people connects and have conversation, create various contents on the internet, share there view, thoughts and information. This Information and thoughts contains images, Text, GIF, and text. If one follower of the other account want to see the posts and Social media is becoming an important role for the business purpose as well and common place for product launching and spreading the business ideas, According to the survey of American Red Cross(2012) social media is the forth most important plate-form to obtain information about the users[5].

### **II. LITERATURE SURVEY**

This project is good for web-development learners to and can also be done further research in the social media as this field is increasing faster. Social tweet contains various analytic plate-form, services, data, and tools. People can interact with other and can give there feedback.java language is an language this language can be used for program analytic[7]. In this new age technology is steadily permeating

everyday life of people. There are some efforts are needed to inform them and awareness about the negative consequences of social media usage. Parents must be aware of how networking usage might affect their children.

In recent years, the advancement of social media in new age technology Social media plate-form is experiencing popularity and the way children's and the young generation communicate and interacting with the world around them. It is way more dangerous for the parents to safeguard there children they can affected by the threats posed by digital media.

Social tweet also shows trending topics and you can also set up your interest in different things like game, politics, information about different apps and more. One can also give the recommendations and make user interact towards the website. Social Tweet is the best platform for sharing post which can only be seen by their followers. Just like Instagram and Facebook it has provided a user friendly interface and social media web application.

Different social networking sites can have a variety of features and diversity in user base. Some of the commonly seen features include blogging technology, messaging services and multimedia sharing. Out of these, social networking sites with blogging features became one of the more popular choices[8]. Social media refers to online platforms enabling individuals to create a public or semi-public profile, establish connections with other users, and navigate through their connections and those formed by others within the system[9].

Different social networking sites can have a variety of features and diversity in user base. Some of the commonly seen features include blogging technology, messaging services and multimedia sharing. Out of these, social networking sites with blogging features became one of the more popular choices[8]. Twitter has over 145 million users today and averages about 90 million new tweets posted on the platform every day. Tweets have a limit of 140 characters and may be used for different purposes by users such as adding an update, how they are doing or what they are feeling, etc[10].

### III. USE CASE DIAGRAM

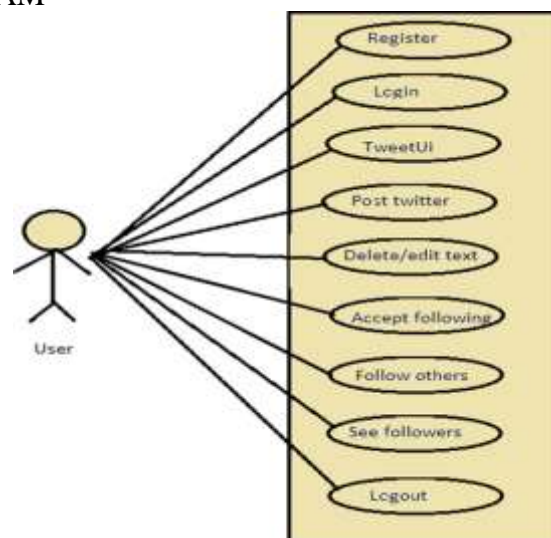

Figure 1: Use case diagram



Figure 2: Front page

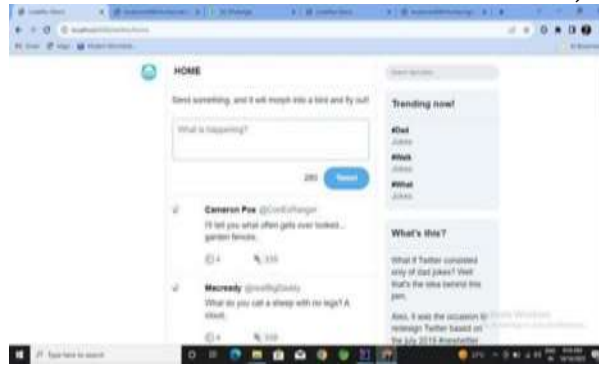

Figure 3: Snapshot of the UI

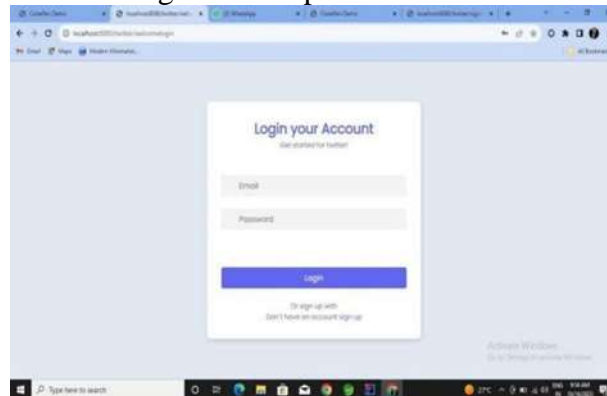

Figure 4: Login page



Figure 5: Profile page

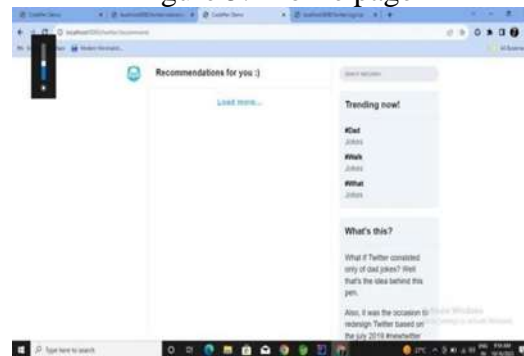

Figure 6: Recommendation panel

#### IV. METHODOLOGY

Developed a platform where everyone can post their tweet which can be shown to followers. Worked on implementing features like Login, Sign up, Create Tweet, Follow User, UN-follow user, and UI screens. Used PostgreSQL as database, Spring MVC framework for back-end, J query, HTML, and JavaScript. REST API were tested to take an average serving speed below 50 ms on local host. Users have to register themselves then after only they can able to login and visit the Twitter main page where they can create tweet and add friends, delete followers and share their thoughts with the known ones .

## V. CONCLUSION

According to our research, social Tweet is a network-based platform and uses different terminologies to work coded in java we have used various front-end and back-end technology to store data, login, logout option using various id's and interact with the other users using various emoji and talk to their friend.

## VI. FUTURE SCOPE

The future scope of our project will extend. It could use a social web application like Facebook, Instagram for sharing posts and thoughts and connecting with people. In future there is more research on the topic of social media and this field is growing very fast in the social world. People are connecting and meeting virtually and sharing their knowledge.

## REFERENCES

- [1] Multilevel exploration in Twitter social stream, Luigi Lancieri, Pomain Giovanetti. Published- August 2016.
- [2] Demystifying the Messaging platform's Ecosystem Through the Lens of Twitter, Mohamad Hoseini, Philippe Melo, Monoel Junior, Fabricio Benevenuto, Balakrishnan Chandrasekaran, Anja Feldmann, Published - 27 October 2020.
- [3] Piotr Brodka, Mateusz Sobas and Henric Johnson, "Profile Cloning Detection in Social Networks", 2014 European Network Intelligence Conference.
- [4] Alireza mohammadinodooshan, William Holmgren, Martin Cristensson, Niklas Carlsson Linköping University, Sweden "A Clone-based Analysis of the Content- Agnostic Factors Driving News Article Popularity on Twitter".
- [5] Social Media: Powerful Tools for SH&E Professionals, Pamela Walaski, Prof. Safety.
- [6] International Research Journal of Engineering and Technology (IRJET), VSM Collage of Engineering, Ramachandrapuram.
- [7] Social media analytics: a survey of techniques, tools, and platforms, Bogdan Batrinca, Phillip C. Treleven.
- [8] "Social Network Sites: Definition, History, and Scholarship" danah m. boyd, Nicole B. Ellison.
- [9] Exploring the Role of Social Media Use Motives, Psychological Well-Being, Self- Esteem, and Affect in Problematic Social Media Use; Bruno Schivinski, Magdalena Brzozowska-Woś, Ellena Stansbury, Jason Satel, Christian Montag, and Halley M. Pontes.
- [10] "Social Media? Get serious! Understanding the functional building blocks of social media" Jan H. Kietzmann, Kristopher Hermkens, Ian P. McCarthy, Bruno S. Silvestre.